

Information

always your partner

EBS SARS-CoV-2 Ag Rapid Test



Lateral Flow Test for the fast determination of SARS-CoV-2 Antigen in nasopharyngeal swab samples

- Fast and simple to use test devices
- Prefilled extraction tube with dropper cap reducing pipetting steps
- 10 minutes to result
- Clinically validated with 271 samples:
 - Diagnostic Sensitivity: 95,0%
 - Diagnostic Specificity: 99,1%
 - Coincidence: 98,2%

Test principle	Detection of SARS-CoV-2 Nucleocapsid-Antigen
Technology	Qualitative Immunoassay on lateral flow format
Sample type	Nasopharyngeal smear sample (swab)
Time to result	10 minutes
Analytical sensitivity	Lower level of detection: 1,6x10 ² TCID ₅₀ /ml*
Diagnostic sensitivity	95,0% (57/60) using PCR CutOff of CT 38
Diagnostic specificity	99,1% (209/211) using PCR CutOff of CT 38
Description	EBS SARS-CoV-2 Ag Rapid Test
Produced by	EurobioScientific, Les Ulis, France
Packaging	20 tests
Reference	EBS 1020

* 50% tissue culture infective dose (TCID₅₀) is the measure of infectious virus titer.

Assay flow

8. Specimen extraction

8.1 Remove the sealing film of the tube with extraction buffer and insert the extraction tube into the Tube rack;

8.2 Insert the swab into the extraction tube containing extraction buffer;

8.3 Rotate the swab at least 6 times while pressing the head against the bottom and sides of the extraction tube;

8.4 Place the swab in the extraction tube for 1 minute;

8.5 Remove the swab from the extraction tube.

8.6 Press the nozzle cap tightly onto the tube. The extracted solution will be used as a test sample.

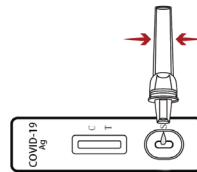
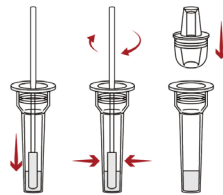
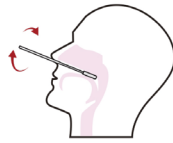

9. TEST PROCEDURE

9.1 Carefully refer to the instruction for use prior to performing the test;

9.2 Take out the kits 30 mins before test, ensure that tests and samples are at room temperature;

9.3 Place test cassettes on flat and clean bench; add 2 drops unknown extracted samples into sample pad;

9.4 Read and record the results after 10 minutes (No longer than 20 minutes). Abnormal results may occur after 20 minutes.

10. INTERPRETATION of RESULTS

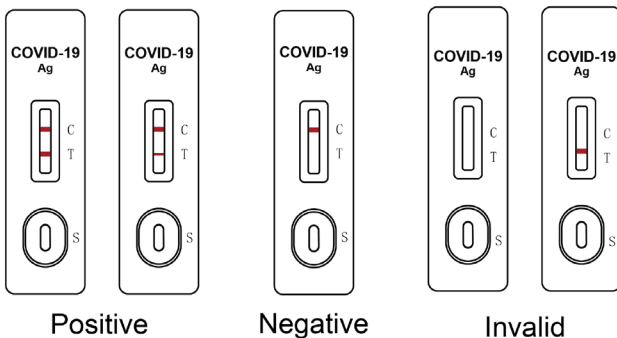

Für weitere Informationen wenden Sie sich bitte an:
For further information please contact:
Pour plus d'information, veuillez contacter:

www.tecomedical.com



A EUROBIO SCIENTIFIC COMPANY

Switzerland / Headquarters

TECOmedical AG

Gewerbestrasse 10
4450 Sissach

Phone +41 61 985 81 00

Fax +41 61 985 81 09

Mail info@tecomedical.com

Germany

TECOmedical GmbH

Wasserbreite 57
32257 Bünde

Phone +49 52 23 985 99 99

Fax +49 52 23 985 99 98

Mail info@tecomedical.com

Benelux

TECOmedical Benelux BV

Computerweg 22
3542 DR Utrecht, The Netherlands

Phone +31 30 307 87 30

Fax +31 30 307 49 39

Mail benelux@tecomedical.com

Austria

TECOmedical AG

Phone 0800 20 40 66

Fax 0800 20 40 55

Mail info@tecomedical.com